

**THE COUNCIL OF THE CITY AND COUNTY OF SWANSEA
CYNGOR DINAS A SIR ABERTAW
PROPOSED TRAFFIC REGULATION ORDER
FREDERICK PLACE, LLANSAMLET
WAITING RESTRICTION
NOTICE 2024**

NOTICE is hereby given that the Council of the City and County of Swansea intends to make an Order in pursuance of its powers as contained in the Road Traffic Regulation Act 1984 (as amended) (“the Act”) the effect of which is as set out in the Schedule(s) below. A copy of the proposed Order, Statement of Reasons and an appropriate plan may be inspected during normal office hours at the Civic Centre Oystermouth Road Swansea SA1 3SN. Any objections to the proposals should be submitted in writing setting out the reasons thereto to reach the undersigned at the above address or via E-mail at Legal.TrafficNotices@swansea.gov.uk by the 10th June 2024 quoting reference DVT- 00277079/EE.

SCHEDULES

FREDERICK PLACE, LLANSAMLET

SCHEDULE 1

REVOCATIONS

The existing Orders are revoked insofar as they are inconsistent with the proposals hereinafter contained which relate to the length or lengths of the road or roads referred to in the schedules hereto.

SCHEDULE 2

NO WAITING AT ANY TIME

FREDERICK PLACE

On its northern western side from its junction with the north-eastern kerbline of Clos yr Ysgol north-eastwards to its closed end, a distance of approximately 69 metres, around its closed end and on its south-eastern side from its closed end south-westwards to the north-eastern boundary of property number 166 Frederick Place, a distance of approximately 26 metres.

20th May 2024

Tracey Meredith

Chief Legal Officer / Prif Swyddog Cyfreithiol



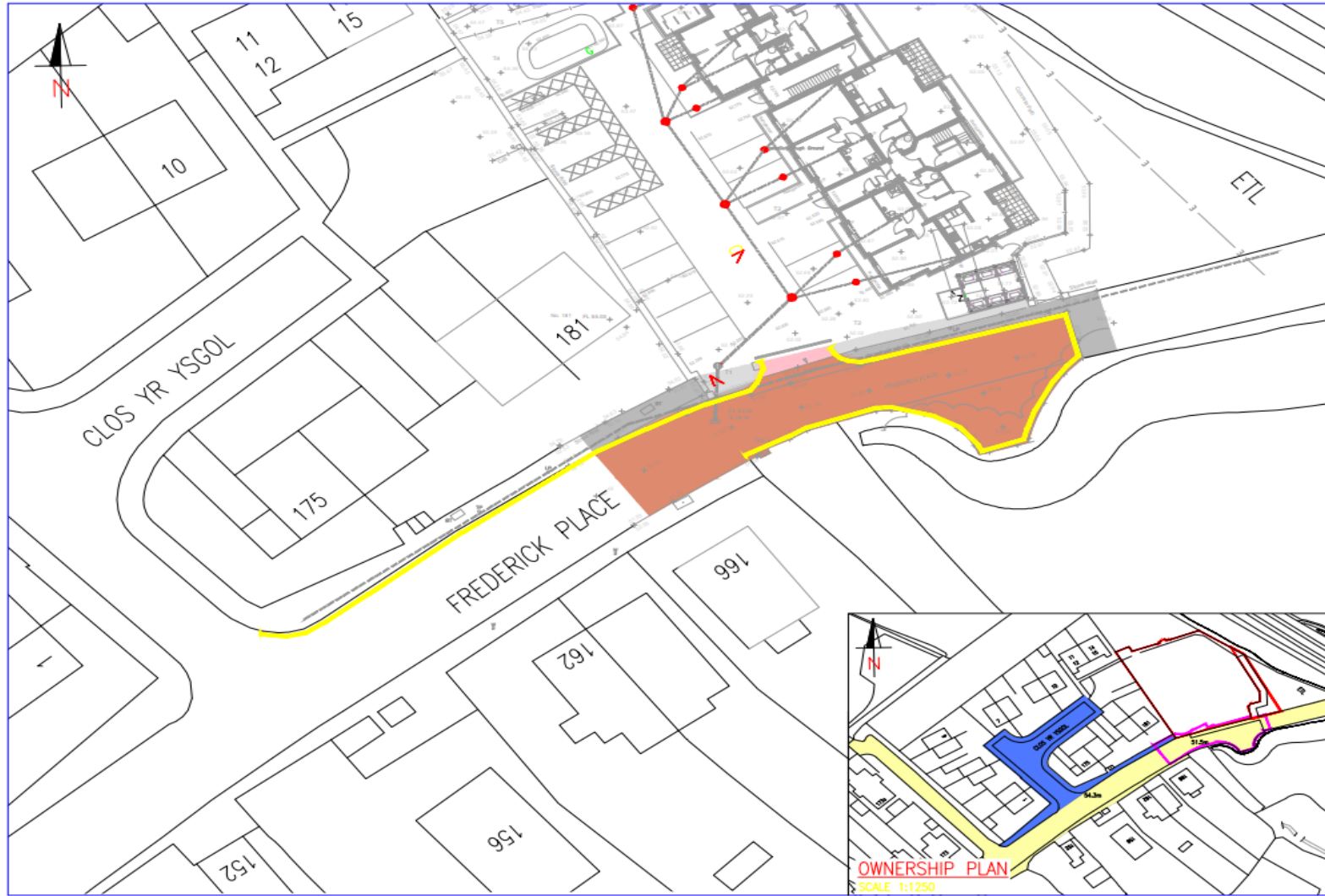

- GENERAL NOTES**
1. DO NOT SCALE THIS DRAWING.
 2. CONTRACTOR TO CHECK ALL DIMENSIONS AND REPORT ALL ERRORS AND OMISSIONS TO THE ENGINEER.
 3. ANY DISCREPANCY TO BE REPORTED IMMEDIATELY TO THE ENGINEER.
 4. THIS DRAWING TO BE READ IN CONJUNCTION WITH ALL RELEVANT ARCHITECTS, SUBCONTRACTORS AND SPECIALISTS DRAWINGS AND SPECIFICATIONS.

Proposed Prohibition of Waiting At Any Time Traffic Regulation Order

Rev.	Detail	By	Date

Reinforcement schedule nos.

CB3
CONSULT
Structural & Civil Engineering Consultants

First Floor
7 St James Crescent
Swansea
SA1 1QB

Telephone: +44 1792 472 182
e-mail: admin@cb3consult.co.uk
web: www.cb3consult.co.uk

Client: **CASTELL GROUP**

Project: **PROPOSED RESIDENTIAL DEVELOPMENT AT FREDRICK PLACE, LLANSAMLET**

Drawing Title: **SECTION 278 PROPOSED TRAFFIC REGULATION ORDERS**

CLLR CONSULTATION

Project No:	C1565	Drawing No:	C-S278-02
Scale:	NTS	Client:	Mar'23
Author:	MU	Checked:	MT
Drawn:		Sheet Size:	A3

OWNERSHIP PLAN
SCALE 1:1250

© This drawing may not be copied without prior written permission

STATEMENT OF REASONS

Notice of Intent for the Traffic Regulation Order

FREDERICK PLACE, LLANSAMLET

To prevent obstructive parking during the housing construction phase and thereafter.

Extract from RTRA 1984

2 What a traffic regulation order may provide.

(1) A traffic regulation order may make any provision prohibiting, restricting or regulating the use of a road, or of any part of the width of a road, by vehicular traffic, or by vehicular traffic of any class specified in the order,—

(a) either generally or subject to such exceptions as may be specified in the order or determined in a manner provided for by it, and

(b) subject to such exceptions as may be so specified or determined, either at all times or at times, on days or during periods so specified.

**THE COUNCIL OF THE CITY
AND COUNTY OF SWANSEA
CYNGOR DINAS A SIR ABERTAWE**



**PROPOSED TRAFFIC REGULATION
FREDERICK PLACE, LLANSAMLET
WAITING RESTRICTION
ORDER 2024**

DVT- 00277079/EE

**THE COUNCIL OF THE CITY
AND COUNTY OF SWANSEA
CYNGOR DINAS A SIR ABERTAWE
FREDERICK PLACE, LLANSAMLET
WAITING RESTRICTION
ORDER 2024**

THE COUNCIL OF THE CITY AND COUNTY OF SWANSEA (hereinafter called “the Council”) in exercise of its powers under Sections the Road Traffic Regulation Act 1984, as amended (hereinafter referred to as “the Act of 1984”) and the Traffic Management Act 2004 and the Local Government (Miscellaneous Provisions) Act 1976 and of all other enabling powers and after consultation with the Chief Officer of Police in accordance with Part III of Schedule 9 and Section 124 of the Act of 1984 hereby make the following Order.

SECTION 1 – PRELIMINARY

Citation and commencement

1. This Order shall come into operation on xx xxxxxxx 2024 and may be cited as the Council of the City and County of Swansea in Frederick Place, Llansamlet (Waiting Restrictions), Traffic Regulation Order 2024

Definitions

2. In this order, except where the context otherwise requires, the following expressions have the meaning hereby respectively assigned to them:

“Civil Enforcement Officer” has the same meaning as in Section 63A of the Act of 1984 and by virtue of Section 76 of the 2004 Act a Civil Enforcement Officer appointed under Section 63A of the Act of 1984 is a Civil Enforcement Officer in relation to parking contraventions;

“Disabled Person’s Vehicle” has the same meaning as in the Local Authorities’ Traffic Orders (Exemption for Disabled Persons) (Wales) Regulations 2000;

“Disabled Person’s Badge” has the same meaning as in the Disabled Persons (Badges for Motor Vehicles)(Wales) Regulation 2000;

“Parking Disc” means a disc and time clock (where appropriate) issued by a Local Authority complying with the requirements of the British Standard

Specifications for Parking Discs to comply with the European Blue Badge Scheme being a disc coloured blue and capable of showing the quarter hour period during which a period of waiting begins;

“Relevant Position” in respect of:-

- (a) a Disabled Person’s Badge and parking disc has the same meaning as in the Local Authorities’ Traffic Orders (Exemptions for Disabled Persons) (Wales) Regulations 2000; and
- (b) a Waiver means exhibited on the windscreen, dashboard or fascia of the vehicle or, where the vehicle does not have a windscreen, dashboard or fascia, in a conspicuous position on the vehicle so that the whole of the information on the front of the waiver is clearly legible from outside the vehicle;

“Waiver” means a Waiver issued by the Council in respect of vehicles being used for building maintenance repair shop fitting or other industrial or demolition operations and the Council may charge for such Waiver such charge to be determined from time to time by resolution of the Council or relevant Committee thereof;

Interpretation

- 3. Except where otherwise stated, any reference in this Order to a numbered Article or Schedule is a reference to the Article or Schedule bearing that number in this Order
- 4. The Interpretation Act 1978 shall apply for the interpretation of this Order as it applies for the Interpretation of an Act of Parliament
- 5. The prohibitions and restrictions imposed by this Order shall be in addition to and not in derogation of any other prohibition or restriction whether made under the Act of 1984 or otherwise

SECTION 2 – NO WAITING AT ANY TIME

6. Save as provided in Articles 7 and 8 no person shall, except upon the direction or with the permission of a Civil Enforcement Officer, police officer in uniform, or a person authorised by the Council, cause or permit any vehicle to wait at any time on the length or lengths of the road or roads referred to in Schedule 2 hereto.

Exemptions

7. Nothing in Article 6 of this Order shall render it unlawful to cause or permit any vehicle to wait on the side or sides or length or lengths of the road or roads specified therein for as long as may be necessary to enable:-
 - (a) the vehicle, if it cannot conveniently be used for such purpose in any other road, to be used in connection with any of the following operations namely:-
 - (i) building, maintenance, repair, shop fitting or other industrial or demolition operations with a Waiver issued by the Council and displayed in the Relevant Position on the windscreen of the vehicle;
 - (ii) the removal of any obstruction to traffic;
 - (iii) the laying, erection, alteration or repair in or on land adjacent to the said lengths or sides of the road of any sewer or any main pipe or apparatus for the supply of water, gas electricity or of any telecommunications apparatus as defined by the Telecommunications Act 1984
 - (iv) a vehicle being used for police, ambulance, fire brigade or other emergency purposes
 - (b) the vehicle if it cannot conveniently be used for such purpose in any other road, to be used in connection with the service of a local authority or of a water authority in pursuance of its statutory powers and duties.

(c) the vehicle of the Royal Mail or other universal services provider as defined in Section 27 of the Postal Services Act 2011 to be used for the purpose of delivering or collecting mail.

(d) vehicles picking up and dropping off passengers

8. Nothing in Article 6 of this Order shall render it unlawful to cause or permit a Disabled Person's Vehicle which displays in the Relevant Position a Disabled Persons Badge and a Parking Disc (on which the driver, or other person in charge of the vehicle, has marked the time at which the period of waiting began) to wait on lengths of sides of roads referred to in the Article for a period not exceeding 3 hours (not being a period separated by an interval of less than 1 hour from the previous period of waiting by the same vehicle on the same length of side of road on which that vehicle had previously been waiting).

REVOCATION

9. The existing Orders are revoked insofar as they are inconsistent with the proposals contained in the schedules hereto and insofar as they relate to the length or lengths of the road or roads referred to in the Schedule hereto

SCHEDULES

FREDERICK PLACE, LLANSAMLET

SCHEDULE 1

REVOCATIONS

The existing Orders are revoked insofar as they are inconsistent with the proposals hereinafter contained which relate to the length or lengths of the road or roads referred to in the schedules hereto.

SCHEDULE 2

NO WAITING AT ANY TIME

FREDERICK PLACE

On its northern western side from its junction with the north-eastern kerbline of Clos yr Ysgol north-eastwards to its closed end, a distance of approximately 69 metres, around its closed end and on its south-eastern side from its closed end south-westwards to the north-eastern boundary of property number 166 Frederick Place, a distance of approximately 26 metres.

Dated this

THE COMMON SEAL OF THE)
COUNCIL OF THE CITY AND)
COUNTY OF SWANSEA)
was hereunto affixed)
in the presence of)

Authorised Signatory